



TIRE SERVICE INTERNATIONAL

WS-5 Mobile Wheel Work Station

buyTSI.com - 800.223.4540



* Impact Wrench Not Included



READ INSTRUCTIONS THOROUGHLY BEFORE OPERATING

Tire Service International, LLC

3451 S. 40TH ST.
Phoenix, AZ 85040

Office: 602.437.5020
Email: sales@buytsi.com
Fax: 602.437.5025

Contact us for any assistance

800.223.4540

Revised: March 2024

General Description

Designed for faster and more efficient commercial truck tire and wheel changing operations

- Supports the weight of most impact wrenches
- WS-5 moves in all directions and locks the impact wrench into a horizontal plane to prevent rounding of wheel nuts
- Provides significant reduction in impact wrench damage
- Relieves operator fatigue and helps reduce comp claims by preventing back injury.

Safety Requirements

1. READ THIS MANUAL BEFORE OPERATING

2. SAFETY GLASSES ARE REQUIRED

3. Do not wear loose clothing.

4. Before each use visually inspect the following items:

A. Check for loose bolts, fittings, leaking air, and damaged hoses

B. Clean floor in the working area

5. The *red hose* is a high pressure line and can be used with jacks to lift up the vehicle or other tools requiring high pressure air. The blue hose is a regulated line, used for checking and adjusting the pressure of a tire. Please install appropriate accessories to these lines before hooking up the main line.

Installation Requirements

Air Supply

Set-Up Instruction

- Prepare a clean and level surface with adequate room to assemble unit
- Remove machine from package and inspect for any damage
- Tighten all fasteners
- Mount the impact wrench (not included)
- Attach air lines in proper ports (red to high pressure - blue to regulated)
- Attach supply air line

Primary Parts

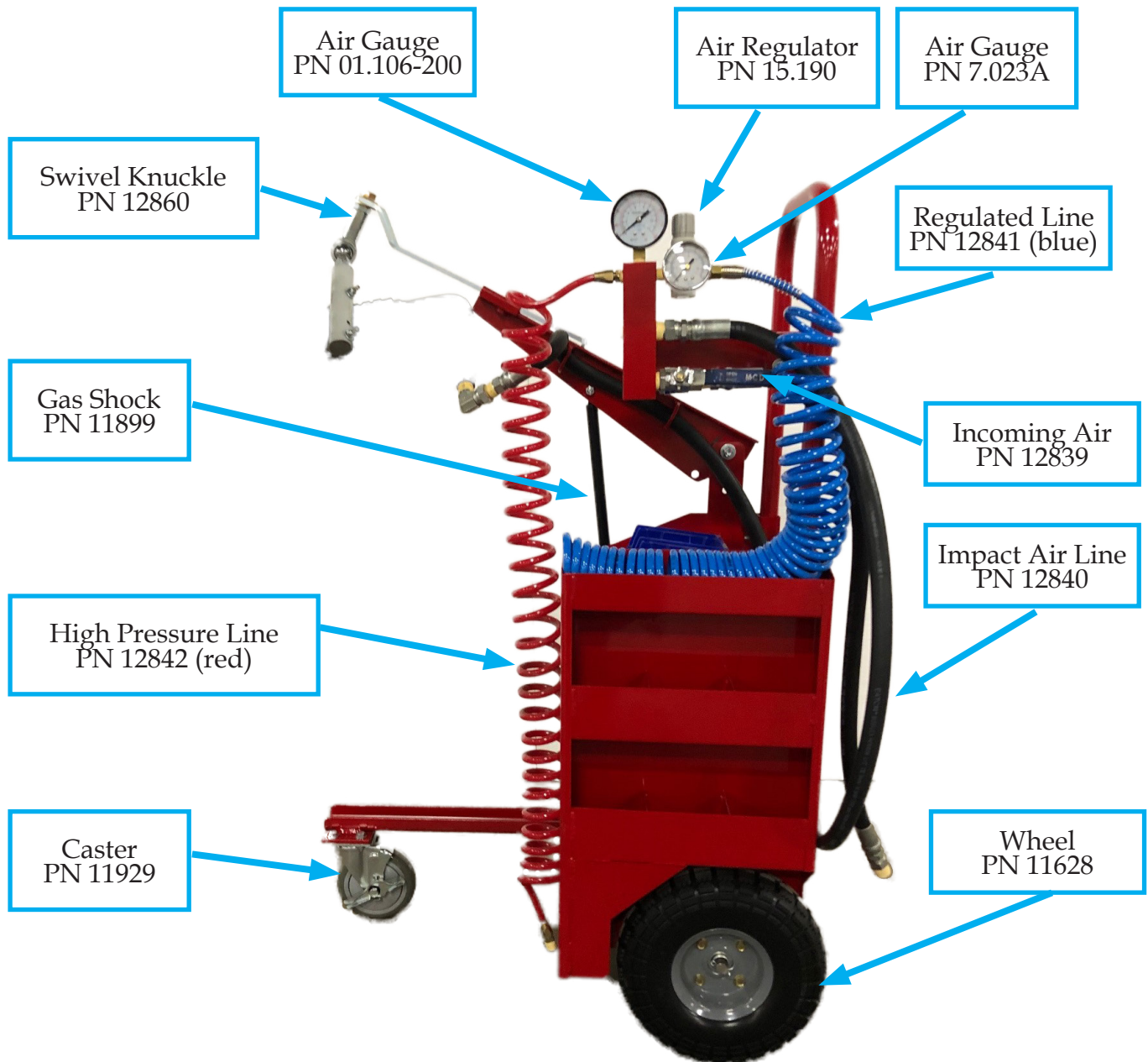

Detailed Set-Up Instructions

- Attach the handle to the impact wrench with the appropriate size U-Bolt. Be sure the wrench is secure.

Fig. 1

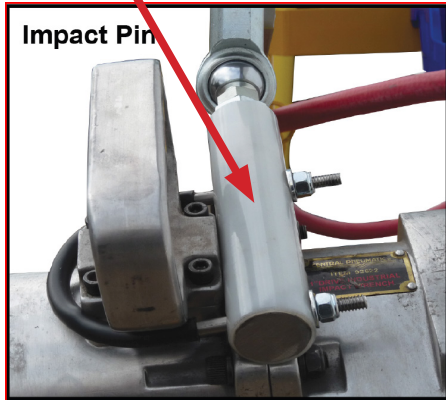

- The wrench arm should freely move to allow the operator to position the wrench securely to the wheel nut

Fig. 2

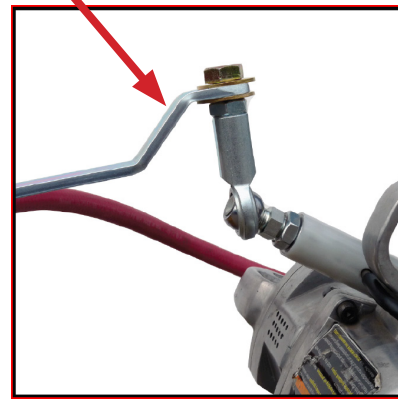

- Install street elbow to wrench using Teflon tape.
- After properly installing the elbow, hook up the air line to the elbow.

Fig. 3

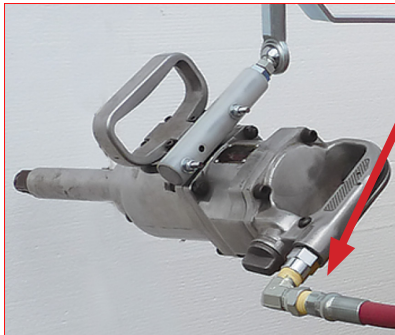

- Be sure to attach the air hoses to the proper port.
- SUPPLY - HIGH PRESSURE - REGULATED

Fig. 4

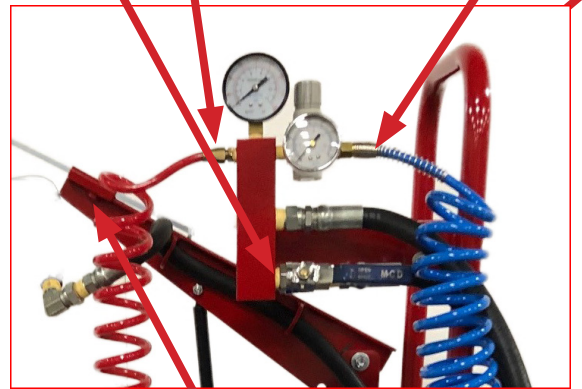

- Be sure to tighten two set screws under wrench arm along with the thumb screw on the rear of the arm. This must be secure for safe operation.



- Please follow manufacturer's specifications on air supply to wrench and or accessories.
- Tire Service International is not responsible for any damage caused by high pressure aire supply damage.

Operating Instructions

Preparation

- Have the vehicle on a lift or jack stands with the tire accessible.
- Provide clean and clear access to the wheel hub so the wrench can be used without issue.
- Have personal protection equipment on
- Have air supply connected and to pressure
- Have regulated air pressure to match suggested tire pressure

Operation

- Move cart close to wheel so wrench is straight and can be firmly affixed to the wheel nut
- Open the main air valve on the supplied air line
- Use the wrench to remove or install the wheel nut
- Trays are provided to hold wheel nuts which can be removed as needed
- Additional storage compartments are located on the side of the unit

Tire Pressure

- Hook up the air chuck to the blue hose (regulated line) and use it to inflate the tire.
- This is for adjusting the final pressure in the tire and not to be used as the initial inflation as proper cage and equipment is required for mounting the tire on the rim
- To check the tire pressure, shut the main valve and this will display the air pressure of the tire.

Maintenance

- It is important to contact your vendor and re-order a new gas shock replacement if it unable to maintain the control of the wrench. This is not a "car shock", but has been specified for this application. Replacing this shock with a non-OEM design can potentially cause damage or personal injury. It is dangerous to use a worn out shock and it needs to be replaced when it is difficult to operate or after approximately two years of service.
- The manifold has a plug that has an oil access area to oil the impact wrench

Parts Listing

ASSEMBLY

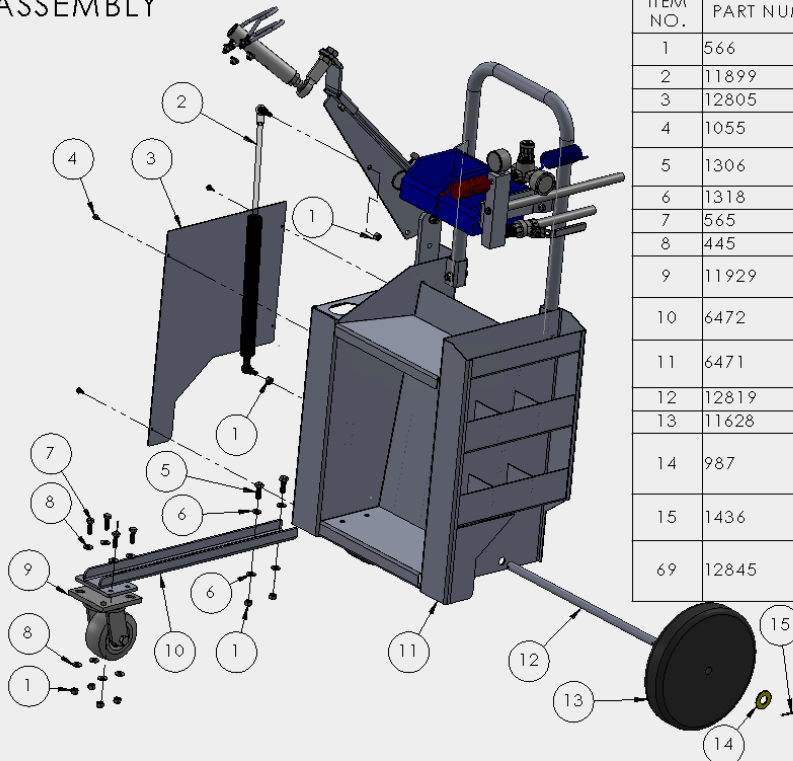

ITEM NO.	PART NUMBER	DESCRIPTION	QTY.
1	566	5/16-18 LOCK NUT	8
2	11899	GAS SHOCK	1
3	12805	SIDE COVER	1
4	1055	HHST #10-24 X 1/2	4
5	1306	HHCS 3/8-16 X 1.0	2
6	1318	5/16 WASHER	4
7	565	5/16-18 x 1 HHCS	4
8	445	1/4 FLAT WASHER	8
9	11929	CASTOR WHEEL, FRONT	1
10	6472	WHEEL ARM WELDMENT	1
11	6471	MAIN FRAME WELDMENT WS-05	1
12	12819	AXLE ROD	1
13	11628	WHEEL	2
14	987	WASHER 5/8 WROUGHT FLAT PLATED	2
15	1436	COTTER PIN 1/8 DIA X 1-1/4 LONG	2
69	12845	PLASTIC HARDWARE TRAY, BLUE	2

SEE DRAWING
 LOUIS W. 1:30
 3/7/2003
 TSI
 WS-5
 WS-5 LOWER ASSEMBLY
 WS-5

ASSEMBLY

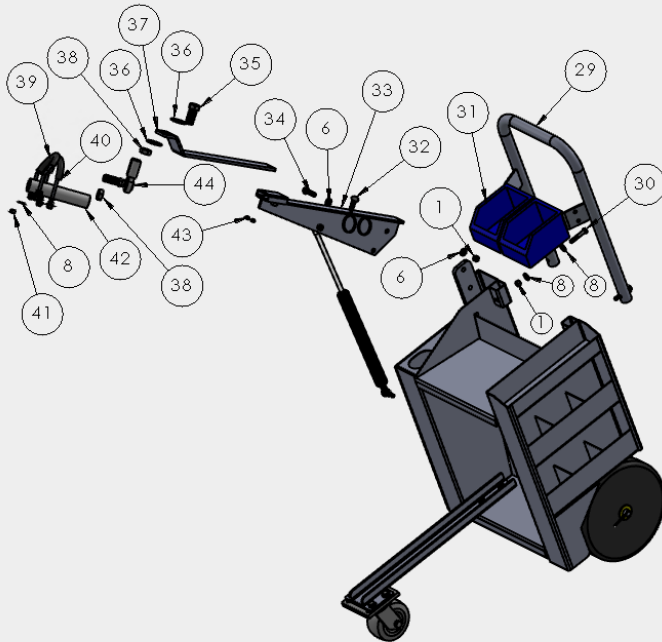

ITEM NO.	PART NUMBER	DESCRIPTION	QTY.
29	6469	HAND RAIL	1
30	3406	HHCS 5/16-18 X 1-3/4	2
8	445	1/4 FLAT WASHER	8
1	566	5/16-18 LOCK NUT	3
6	1318	5/16 WASHER	2
31	12845	PLASTIC HARDWARE TRAY, BLUE	2
32	15222	THUMB SCREW 1/4-20 X 1	1
33	6467	ADJUSTABLE ARM WELDMENT	1
34	447	HHCS 3/8-16 X 1-1/4 LRG	1
35	12859	HCS 5/8-18 X 1-1/2 BOLT	1
36	12861	BRASS 5/8 FLAT WASHER	2
37	12813	ADJUSTABLE ARM BAR	1
38	3671	5/8-11 JAM NUT	2
39	16158	U-BOLT, TUBING (LARGE) ASSEMBLY	1
40	16159	U-BOLT, TUBING (SMALL) ASSEMBLY	1
41	226-N	1/4-20 SELF LOCK	4
42	16157	SLEEVE, LONG BOLT GLUED ASSY.	1
43	1308	SHSS 3/8-16 X 5/16 CUP	2
44	12860	5/8 X 5/8 2 PIECE FEMALE ROD END CF10Y	1

SEE DRAWING
 LOUIS W. 1:30
 3/7/2003
 TSI
 WS-5
 WS-5 UPPER ASSEMBLY
 WS-5

Parts Listing

ASSEMBLY

ITEM NO.	PART NUMBER	DESCRIPTION	QTY.
16	6470	AIR LINE BLOCK	1
17	128-AS	PLUG 1/4 NPT SOCKET HEAD	1
18	12842	AIR LINE, .250 NPT 15' LONG (RED)	1
19	01.106-200	AIR PRESSURE GAUGE, .250 NPT 200 PSI	1
20	778	1/4 NPT Steel Pipe Nipple	1
21	15.190	AIR REGULATOR	1
22	12841	AIR-LINE, 1/4 NPT 15' LONG (BLUE)	1
23	7.023A	AIR GUAGE, 0-160 PSI	1
24	12840	AIR HOSE, 1/2 I.D. W/1/2 NPT FITTING 80" LONG	1
25	12839	AIR HOSE, 1/2 I.D. W/1/2 NPT FITTING 33" LONG	1
26	16081	BALL VALVE 1/2"	1
27	149	NIPPLE 1/2 NPT X CLOSE BLACK	1
28	1737	HHCS 5/16-18 X 3/4 G RS	2
1	566	NUT, HEX 5/16-18 NYLOCK	2

REV	DESCRIPTION	DATE	BY
01	WS-5	2 01 13	
02	WS-5 AIR LINE BLOCK ASSEMBLY		
03	WS-5		

WS-5 - Mobile Work Station

ID	Component	Description	Qty	ID	Component	Description	Qty
01	566	Nut 5/16-18 Nyloc	8	31	12845	Plastic Hardware Tray, Blue	2
02	11899	Gas Shock with ball	1	32	15222	Thumb Screw 1/4-20 x 1 (AM-711-037)	1
03	12805	Side Cover	1	33	6467	Adjustable Arm Weldment	1
04	1055	HHST #10-24 x 1/2	4	34	447	* HHCS 3/8-16 x 1-1/4	1
05	1306	HHCS 3/8-16 x 1	2	35	12859	HCS 5/8-18 x 1 1/2	1
06	1318	* Washer 5/16	6	36	12861	Washer 5/8 Brass Flat	2
07	565	HHCS 5/16-18 x 1 Grade 5	4	37	12813	Adjustable Arm Bar	1
08	445	* Washer 1/4 Flat Wrought	16	38	3671	* Nut 5/8-18 Jam	2
09	11929	Caster Front	1	39	16158	*	1
10	6472	Wheel Arm, Weldment	1	40	16159	*	1
11	6471	Main Frame Weldment WS-5	1	41	226-N	* Nut 1/4-20 Nyloc	4
13	11628	Wheel & Tire Assembly	2	42	16157	*	1
14	987	Washer 5/8 Wrought Flat Plated	2	43	1308	* SHSS 3/8-16 x 5/16 Cup	2
15	1436	Pin, Cotter 1/8 x 1	2	44	12860	5/8 x 5/8 2 piece Female Rod End CF10Y, W	1
16	6470	Air Line Block for WS-5	1				
17	128-AS	Plug 1/4 npt Socket Head	1				
18	12842	Air Line 1/4 NPT 15 Long (Red)	1				
19	01.106-200	Air Pressure Gauge 1/4 NPT 200 PSI	1				
20	778	Nipple 1/4 Black	1				
21	15.190	Regulator, Air 125 PSI	1				
22	12841	Air Line 1/4 NPT 15 Long (Blue)	1				
23	7.023A	Air Pressure Gauge 2" dia x 1/8 npt 0-160 p	1				
24	12840	Air Hose 1/2 ID with 1/2 x 80 inches	1				
25	12839	Air Hose 1/2 ID with 1/2 x 33 inches long	1				
26	16081	Ball Valve 1/2"	1				
27	149	Nipple 1/2 NPT x Close Black	1				
28	1737	HHCS 5/16-18 x 3/4 Grade 5	2				
28	1737	HHCS 5/16-18 x 3/4 Grade 5	2				
29	6469	Hand Rail for WS-5	1				
30	3406	HHCS 5/16-18 x 1-3/4 Grade 5	2				

California Proposition 65

California's Proposition 65 entitles California consumers to special warnings for products that contain chemicals known to the state of California to cause cancer and birth defects or other reproductive harm if those products expose consumers to such chemicals above certain threshold levels.

WARNING: Some of Tire Service International's products can expose you to chemicals including chromium compounds, which are known to the State of California to cause cancer, birth defects or other reproductive harm. For more information, go to www.P65Warnings.ca.gov.

Your risk from exposure to these chemicals varies, depending on exposure time. To reduce your exposure, work in a well-ventilated area and with approved safety equipment, such as dust masks that are specially designed to filter out microscopic particles. Wash your hands after touching TSI's products.

Warranty and Return Policy

Warranty & Workmanship you can depend on.

With over 30 years of manufacturing experience we maintain the ability to provide competitive prices while employing and manufacturing the majority of our products in the USA. Pride in our workmanship and standing behind each and every product is not just our claim but our uncompromising responsibility.

Tire Service International equipment is warranted to be free from defects in materials and workmanship for a period of one year from the date of original purchase to the original owner. Repair labor is warranted for 90 days from the date of original purchase. Bushings, blades, bearings and normal wear and tear are not covered under warranty. Careless handling, negligence, misuse, abuse, mutilation, improper operation, making unauthorized repairs, additions, and or alterations automatically cancel this warranty and relieves TSI of any obligation. Cheetah tanks claimed to be defective while under warranty will be evaluated at our manufacturing plant and either repaired if possible or exchanged and returned or credit issued to the customer account at our discretion. Damage resulting from dropping the tanks will not receive warranty consideration. Warranty parts need to be returned prepaid to the plant for credit. Any replacement parts shipped from the plant will be shipped at the customer's expense. Machines requiring warranty work must be brought to the manufacturing plant in 201 Chelsea Rd, Monticello, MN or to a repair facility authorized by TSI.

!!WARNING!! Goods returned without an RGA will be refused. A Returned Goods Authorization form must be obtained before returning any material or goods. All non-warranty returns will be subject to a 15% restocking fee plus any additional charges for reconditioning/repacking.

Visit www.buyTSI.com for any additional information. Also be sure to follow us on all the Socials, and subscribe to our YouTube channel for all our product videos.

No part of this manual may be reproduced without specific approval from
Tire Service International, LLC.

Copyright © 2024 Tire Service International, LLC

